

ventilation products

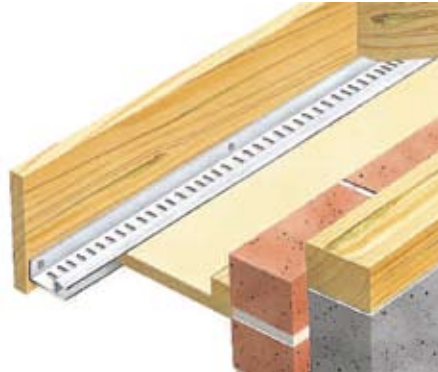

EXTERNAL & ROOF VENTILATORS

Continuous Soffit Vent Strip

DESCRIPTION	SIZE	UNIT
Black, Brown or White	2.4m	length

Supplied in 2.4 metre lengths, this extruded UPVC product provides 11,075mm² per metre run of net eaves ventilation, to meet the requirements of the building regulations F2 and NHBC requirements.

Circular Soffit Vent (Push and Lock)

DESCRIPTION	SIZE	UNIT
White, Brown and Black	73mm diameter	each

Suitable for ventilating new or old structures with quick and easy installation via a 70mm diameter hole.

When fitting at 140mm centres, net eaves ventilation of 10,046mm² per metre run is achieved.

Over Fascia Vent

DESCRIPTION	SIZE	UNIT
Black or White	1000mm x 10mm airflow	each
Black Only	500mm x 25mm airflow	each

Used in newbuild or refurbishment, where the fascia board is fitted to the ends of the rafters creating a situation where ventilation can only be achieved over the top of the board.

The vent is fixed to the top of the fascia board and the felt then placed on top of the vent after being fixed to the rafters.

Roof Ventilator

DESCRIPTION	SIZE	UNIT
	900mm	length

Available in 400mm, 450mm and 600mm centres to provide airflow into the flat roof space. When fixed between standard trusses on both flanges, a 25mm channel is immediately formed to give net ventilation per metre run of eaves of 13,500mm² at 600mm centres (taken between trusses)

Roof Ventilator - Open Eaves (Cottage Style)

Available in 400mm, 450mm and 600mm centres to ensure ventilation to open eaves construction via the slotted air inlet. Fixed with the air inlet lapping over the external brickwork giving net ventilation per metre run of eaves of 11,075mm².

Roll Form Eaves Ventilator

DESCRIPTION	SIZE	UNIT
Universal Centres	6m	length

Available in 6 metre long rolls giving a universal design for truss centre. 400mm to 600mm or irregular spacing.

Provides free airflow of 10-25mm.



ventilation products

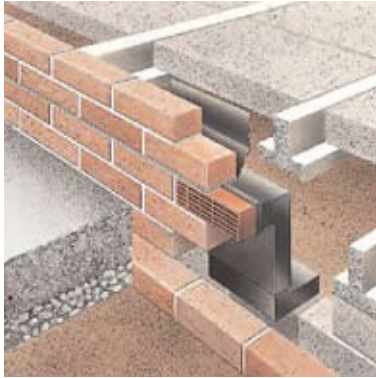

Combination Airbrick

DESCRIPTION	SIZE	UNIT
Terracotta, Buff, Brown and Blue/Black	225mm x 65mm	each

Used in conjunction with the telescopic underfloor vent to provide approximately 6600mm² of free airflow (which complies with the 1985 building regulations and the recommendations of the NHBC) when spaced every 2.2 metres.

These 9"x 3" airbricks can be clipped together to obtain required brickwork coursings.

Box quantity: 20

Telescopic Underfloor Vent

DESCRIPTION	SIZE	UNIT
Black (use with combination Airbrick)		each
Underfloor Duct Adapter to 100mm Pipe		each
Vertical Extension Sleeve used in conjunction with the above		each

Used in conjunction with the combination airbrick to achieve approximately 6600mm² of free airflow (which complies with the latest building regulations 1985 C4 and the recommendations of the NHBC). Installed in normal brickwork below the DPC and adjusted to three or four courses as required, or it may be cut down to two courses.

Box quantity: As required

Vertical Extension Sleeve

Used in conjunction with the telescopic underfloor vent to provide an extension between 5 and 9 brickwork courses.

Box quantity: As required

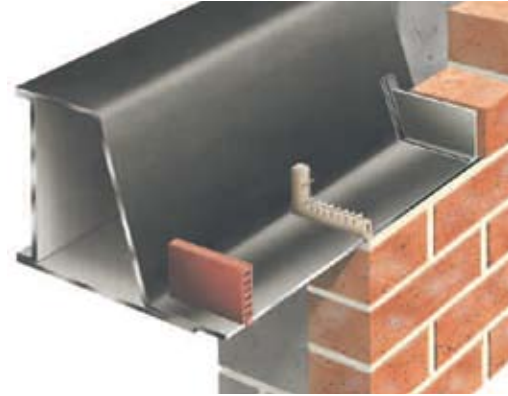

Cavity Wall Weep Vent

A preformed duct designed to replace a perpendicular mortar joint and to allow water gathered by cavity trays and DPCs to be discharged through the outer leaf and also to provide ventilation.

To be installed at maximum 1 metre centres (ie. every fourth perpendicular joint to comply with building regulations, BS5628 part 3 and BS8215. When working to NHBC standards, install at maximum 450mm centres (ie. every other perpendicular joint).

Colours: Red, Buff, Black, Grey, White and Clear.

In both standard and 'Tunnel' Tape.